

NOTICE!!

These documents have been scanned!

Do not place un-scanned documents beneath this notice!

Do not remove this notice from this file!

GPO Jacket No. 560-102
Print Order 61540
Rise Business Services, LLC
Job=AZ15 5/1/2019



Box Number= AZ15014



Claim Begin-End: AMC439831-AMC439832

1 Initial Receipt



AZ15014-9

AMC439776-AMC440076



AMC #

DATE CLOSED

ADJ INITIAL

REMARKS

United States Department of the Interior
Bureau of Land Management
 DIV OF LANDS, MINRLS & ENERGY
 ONE N CENTRAL AVE
 PHOENIX, AZ 85004 -4427
 Phone: 602-417-9200

Receipt

No: 3670731

Transaction #: 3775011	
Date of Transaction: 10/03/2016	
CUSTOMER:	
SAM EAKIN 3940 N IRVING ST KINGMAN, AZ 86409-3160 US	

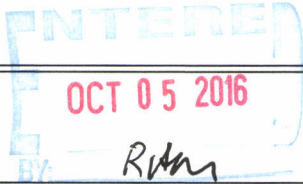

LINE #	QTY	DESCRIPTION	REMARKS	UNIT PRICE	TOTAL
1	2.00	LOCATABLE MINERALS / MINING CLAIMS-NEW, UNADJUD, ONE OR MORE AUTH NOS / NEW MINING CLAIM PROCESSING FEE CASES: AMC439831/\$20.00, AMC439832/\$20.00		- n/a -	40.00
2	2.00	LOCATABLE MINERALS / MINING CLAIMS-NEW, UNADJUD, ONE OR MORE AUTH NOS / NEW MINING CLAIMS LOCATION FEE CASES: AMC439831/\$37.00, AMC439832/\$37.00		- n/a -	74.00
3	2.00	LOCATABLE MINERALS / MINING CLAIMS-NEW, UNADJUD, ONE OR MORE AUTH NOS / NEW MINING CLAIMS MAINTENANCE FEE CASES: AMC439831/\$155.00, AMC439832/\$155.00		- n/a -	310.00
TOTAL:					\$424.00

PAYMENT INFORMATION			
1	AMOUNT:	424.00	POSTMARKED: N/A
	TYPE:	CHECK	RECEIVED: 09/30/2016
	CHECK NO:	1136	
	NAME:	EAKIN, SAM 3940 N IRVING ST KINGMAN AZ 86409-3160 US	

REMARKS
PREVIOUSLY EARNED ON TEMP RECEIPT #184615 - DATED 09/30/2016

This receipt was generated by the automated BLM Collections and Billing System and is a paper representation of a portion of the official electronic record contained therein.

Form 1370-18
(July 1984)

UNITED STATES
DEPARTMENT OF THE INTERIOR
BUREAU OF LAND MANAGEMENT

No 184615

Date 9/30/14

TEMPORARY RECEIPT

Received \$ ck# 1136 \$424

On account of Sam Eakin III

3940 N. Irving St.

Received from: Kingman, AZ 86401

2 new claims AMC 439 831-32

928.279.4396

JM Leadon

Credit is subject to
clearing of any checks
**This is not a permit,
license, or lease.**

ACCOUNTING OFFICE

NOTICE!!

These documents have been scanned!

Do not place un-scanned documents beneath this notice!

Do not remove this notice from this file!

GPO Jacket No. 560-102
Print Order 61540
Rise Business Services, LLC
Job=AZ15 5/1/2019



Box Number= AZ15014



Claim Begin-End: AMC439831-AMC439832

2 Correspondence



AZ15014-9

AMC439776-AMC440076

SENDER: COMPLETE THIS SECTION

- Complete items 1, 2, and 3.
- Print your name and address on the reverse so that we can return the card to you.
- Attach this card to the back of the mailpiece, or on the front if space permits.

1. Article Addressed to:

GOLDEN QUEEN LLC
 316 W 79TH ST APT 1FW
 NEW YORK NY 10024-6125
 4920/RM/AMC439831



9590 9402 2684 6351 9082 60

2. Article Number (Transfer from service label)

7014 2870 0000 1116 1940

COMPLETE THIS SECTION ON DELIVERY**A. Signature****X**

Robert Michael

 Agent Addressee**B. Received by (Printed Name)****C. Date of Delivery****D. Is delivery address different from item 1?** Yes

If YES, enter delivery address below:

 No**3. Service Type**

- Adult Signature
- Adult Signature Restricted Delivery
- Certified Mail®
- Certified Mail Restricted Delivery
- Collect on Delivery
- Collect on Delivery Restricted Delivery

- Priority Mail Express®
- Registered Mail™
- Registered Mail Restricted Delivery
- Return Receipt for Merchandise
- Signature Confirmation™
- Signature Confirmation Restricted Delivery

Restricted Delivery

USPS TRACKING #



First-Class Mail
Postage & Fees Paid
USPS
Permit No. G-10

9590 9402 2684 6351 9082 60

United States
Postal Service

RECEIVED
BLM AZ STATE OFFICE

• Sender: Please print your name, address, and ZIP+4® in this box •

UNITED STATES
 DEPARTMENT OF THE INTERIOR
 Bureau of Land Management
 Arizona State Office
 One N. Central Avenue, Suite 800
 Phoenix, AZ 85004-4427

2017 JUL 27 P 3:11

PHOENIX, ARIZONA



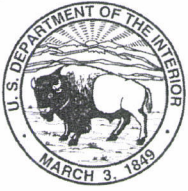

United States Department of the Interior



BUREAU OF LAND MANAGEMENT
Arizona State Office
One North Central Avenue, Suite 800
Phoenix, Arizona 85004-4427
www.blm.gov/az/

JUL 14 2017

In Reply Refer To:
3833 (9200) RM
AMC439831

CERTIFIED MAIL - RETURN RECEIPT REQUESTED No. 7014 2870 0000 1116 1940

NOTICE

GOLDEN QUEEN LLC : This Notice Affects the Claims
316 W 79TH ST APT 1FW : Shown in the Block Below.
NEW YORK, NY 10024-6125 :

AMC439831, AMC439832
GOLDEN QUEEN #1, GOLDEN QUEEN #2

No Rights Acquired on Portions of Lode Claim(s)

Pursuant to Title 43 Code of Federal Regulations 3832.1, this office received your notice(s) of location for recordation of mining claims. However, portions of the lode mining claim(s) listed above appear to lie within lands that are not open to location for the following reason:

The claim is partially located on land that is patented and therefore not open to location. The Federal Government does not administer the surface or subsurface estate.
Patent #774837 dated September 25, 1920.
Patent #859143 dated April 17, 1922.
Patent #946764 dated October 25, 1924.

Therefore, although the claim(s) has/have been recorded, you have acquired no rights on any portion of the subject mining claim(s) that lie within these lands. Enclosed for reference is a copy of the Master Title Plat.

If additional information is required, please contact RéAnn Myers at 602-417-9413. Please include your AMC serial number(s) on all correspondence.



Lucas Lucero
Deputy State Director
Lands, Minerals and Energy Division

Enclosure

USPS Tracking® Results

[FAQs > \(http://faq.usps.com/?articleId=220900\)](http://faq.usps.com/?articleId=220900)

Track Another Package +

Remove X

Tracking Number: 70142870000011161940

 **Delivered**

Product & Tracking Information

[See Available Actions](#)

Postal Product:

Features:
Certified Mail™

DATE & TIME	STATUS OF ITEM	LOCATION
July 21, 2017, 1:54 pm	Delivered, Left with Individual ▲	NEW YORK, NY 10024
Your item was delivered to an individual at the address at 1:54 pm on July 21, 2017 in NEW YORK, NY 10024.		
July 20, 2017, 1:45 pm	Notice Left (No Authorized Recipient Available)	NEW YORK, NY 10024
July 20, 2017, 9:14 am	In Transit to Destination	ON ITS WAY TO NEW YORK, NY 10024
July 20, 2017, 1:59 am	Arrived at Unit	NEW YORK, NY 10024

[See More](#) ▼

Available Actions

- Text Updates** ▼
- Email Updates** ▼

[See Less](#) ▲

Can't find what you're looking for?

Go to our [FAQs](#) section to find answers to your tracking questions.

[FAQs \(http://faq.usps.com/?articleId=220900\)](http://faq.usps.com/?articleId=220900)

NOTICE!!

These documents have been scanned!

Do not place un-scanned documents beneath this notice!

Do not remove this notice from this file!

GPO Jacket No. 560-102
Print Order 61540
Rise Business Services, LLC
Job=AZ15 5/1/2019



Box Number= AZ15014



Claim Begin-End: AMC439831-AMC439832

3 Transfers



AZ15014-9

AMC439776-AMC440076

**NO
DOCUMENTS
FOUND**

NO DOCUMENTS FOUND
NO DOCUMENTS FOUND

NOTICE!!

These documents have been scanned!

Do not place un-scanned documents beneath this notice!

Do not remove this notice from this file!

GPO Jacket No. 560-102
Print Order 61540
Rise Business Services, LLC
Job=AZ15 5/1/2019



Box Number= AZ15014



Claim Begin-End: AMC439831-AMC439832

4 Annual Filings



AZ15014-9

AMC439776-AMC440076

439831

UNITED STATES
DEPARTMENT OF THE INTERIOR
BUREAU OF LAND MANAGEMENT

CREDIT CARD PAYMENT
For Mining Claim Maintenance Fee

THIS IS A CHANGE OF ADDRESS

TELEPHONE SUBMISSION - ACCURACY OF THE BELOW INFORMATION IS THE RESPONSIBILITY OF THE CLAIMANT/OWNER

NAME GOLDEN QUEEN LLC / PATRICA MICHAELS
ADDRESS 316 W. 79TH ST APT: 15W
CITY NEW YORK STATE NY ZIP 10024
PHONE # 212 - 873 - 5356

SEND RECEIPT TO Above address
 Other (Include Name and Mailing Address):

AMC NUMBER CLAIM/SITE NAME
~~360017~~ 439831 GOLDEN QUEEN #1
~~360018~~ 439832 GOLDEN QUEEN #2

2 # of Claim/Site
x 165.00 Each
\$ 330.00 Total Charged PM (INITIALS)
RECEIPT # 4526788

DATE STAMP

RECEIVED
STATE OFFICE
2019 AUG -7 P 3:34
PHOENIX, ARIZONA

***** FOR OFFICIAL USE ONLY *****
DATE ENTERED INITIALS _____ VERIFIED _____

BY: AS
AUG 15 2019

United States Department of the Interior
Bureau of Land Management
 DIV OF LANDS, MINRLS & ENERGY
 ONE N CENTRAL AVE
 PHOENIX, AZ 85004 -4427
 Phone: 602-417-9200

Receipt

No: 4526788

Transaction #: 4647528	
Date of Transaction: 08/07/2019	
CUSTOMER:	
PATRICIA MICHAELS 316 W 79TH ST APT 1-FW NEW YORK, NY 10024-6125 US	

LINE #	QTY	DESCRIPTION	REMARKS	UNIT PRICE	TOTAL
1	1.00	LOCATABLE MINERALS / MINING CLAIMS- NOT NEW-UNADJUD, ONE AUTH NO. ONLY / MINING CLAIM MONEY RECEIVED CASES: AMC360017/\$330.00	2020 MAINT (2)	- n/a -	330.00
TOTAL:					\$330.00

PAYMENT INFORMATION			
NOTE: Items will appear on credit card statement as "Bureau of Land Mgmt CO".			
1	AMOUNT:	330.00	POSTMARKED: N/A
	TYPE:	CREDIT CARD	RECEIVED: 08/07/2019
	NAME:	MICHAELS, PATRICIA 316 W 79TH ST APT 1-FW NEW YORK NY 10024-6125 US	
	CARD NO:	XXXXXXXXXXXX2014	AUTH CODE: 113787
	NAME ON CARD:	PATRICIA G MICHAELS	
	SIGNATURE:	OVER THE PHONE	

REMARKS

This receipt was generated by the automated BLM Collections and Billing System and is a paper representation of a portion of the official electronic record contained therein.

DEPARTMENT OF THE INTERIOR
BUREAU OF LAND MANAGEMENT
MINING CLAIMS

Run Date/Time: 9/11/2018

MC Maintenance Fees Paid Through the BLM Pay Portal
(by Date Paid)

Page 82 Of 723

CBS Receipt: 4241163

Printed For Lead File # AMC439831

Agency Tracking ID: 1534889242

Assessment Year: 2019

Number of BLM Serial Nr: 2

Paid On: 8/21/2018

Total Amount Paid: \$310.00

Claim Name	BLM Serial No	Lead File No	Amount Paid
GOLDEN QUEEN #1	AMC439831	AMC439831	\$155.00
GOLDEN QUEEN #2	AMC439832	AMC439831	\$155.00

United States Department of the Interior
Bureau of Land Management
 BUSINESS & SUPPORT SVCS DIV
 ONE N CENTRAL AVE SUITE 800
 PHOENIX, AZ 85004 -4427
 Phone: 602-417-9200

Receipt

No: 4241163

Transaction #: 4356573	
Date of Transaction: 08/21/2018	
CUSTOMER:	
PATRICIA G MICHAELS 316 W 79TH ST #1 FW NEW YORK, NY 10024 US	

LINE #	QTY	DESCRIPTION	REMARKS	UNIT PRICE	TOTAL
1	1.00	LOCATABLE MINERALS / MINING CLAIMS- NOT NEW-UNADJUD, ONE AUTH NO. ONLY / MINING CLAIM MONEY RECEIVED CASES: AMC439831/\$310.00		- n/a -	310.00
TOTAL:					\$310.00

PAYMENT INFORMATION				
NOTE: Items will appear on credit card statement as "BLM O Mining Claim".				
1	AMOUNT:	310.00	POSTMARKED:	N/A
	TYPE:	CREDIT CARD	RECEIVED:	08/21/2018
	NAME:	PATRICIA G MICHAELS 316 W 79TH ST #1 FW NEW YORK NY 10024 US		
	CARD NO:	XXXXXXXXXXXX2014	AUTH CODE:	220644
	NAME ON CARD:	PATRICIA G MICHAELS		
	SIGNATURE:			

REMARKS

This receipt was generated by the automated BLM Collections and Billing System and is a paper representation of a portion of the official electronic record contained therein.

UNITED STATES
DEPARTMENT OF THE INTERIOR
BUREAU OF LAND MANAGEMENT

439831

CREDIT CARD PAYMENT
For Mining Claim Maintenance Fee

THIS IS A CHANGE OF ADDRESS

TELEPHONE SUBMISSION - ACCURACY OF THE BELOW INFORMATION IS THE RESPONSIBILITY OF THE CLAIMANT/OWNER

NAME KADYN MICHAELS
ADDRESS 316 W 79TH APT 1FW
CITY _____ STATE NY ZIP 10024
PHONE # 917 - 544-5322

SEND RECEIPT TO Above address
 Other (Include Name and Mailing Address):

AMC NUMBER	CLAIM/SITE NAME
<u>439831</u>	<u>GOLDEN QUEEN # 1</u>
<u>439832</u>	<u>GOLDEN QUEEN # 2</u>
_____	_____

2 # of Claim/Site
x 155.00 Each
\$ 310.00 Total Charged PER (INITIALS)
RECEIPT # 3958049

DATE STAMP
2017 AUG 24 P 2:29
PHOENIX, ARIZONA
RECEIVED
BLM AZ STATE OFFICE
ENTERED
AUG 28 2017
BY: RAM

***** FOR OFFICIAL USE ONLY *****
DATE _____ INITIALS _____ VERIFIED _____

**DEPARTMENT OF THE INTERIOR
BUREAU OF LAND MANAGEMENT
MINING CLAIMS
(MASS) Serial Register Page**

Run Date/Time: 08/25/17 10:31 AM

Page 1 of 2

01 05-10-1872;017STAT0091;30USC26,28,34

Total Acres

Serial Number

Case Type 384101: LODE CLAIM

20.660

AMC439831

Claim Name: GOLDEN QUEEN #1

Lead File Number

Case Disposition: ACTIVE

AMC439831

Required Maintenance Fee: \$155.00

Name & Address

Int Rel

GOLDEN QUEEN LLC
316 W 79TH ST APT 1FW NEW YORK, NY 10024-6125

CLAIMANT

County / State

District

MOHAVE County, AZ

COLORADO RIVER DO

Mer Twp Rng Sec

Subdivision

14 0190N 0200W 025

NW

Act Date	Code	Action Text	Action Remarks	Receipt Number
09/29/2016	403	LOCATION DATE		
09/30/2016	395	RECORDATION NOTICE RECD	1	3670731
09/30/2016	484	LOCATION YEAR / MAINTENAN	2017;\$155	3670731
07/14/2017	393	DECISION/NOTICE ISSUED	LODE-NO RIGHTS	
06/19/2017	669	LAND STATUS CHECKED		
09/30/2016	501	ACCT ADV IN LEAD FILE	AMC439831-AMC439832;	
09/29/2016	404	COUNTY RECORDATION	2016044137;	

Line Nr Remarks

RECEIVED
STATE OFFICE
2017 AUG 25 A 9:32
PHOENIX, ARIZONA

**DEPARTMENT OF THE INTERIOR
BUREAU OF LAND MANAGEMENT
MINING CLAIMS
(MASS) Serial Register Page**

Run Date/Time: 08/25/17 10:31 AM

Page 2 of 2

01 05-10-1872;017STAT0091;30USC26,28,34

Total Acres

Serial Number

Case Type 384101: LODE CLAIM

20.660

AMC439832

Claim Name: GOLDEN QUEEN #2

Lead File Number

Case Disposition: ACTIVE

AMC439831

Required Maintenance Fee: \$155.00

Name & Address

Int Rel

GOLDEN QUEEN LLC
316 W 79TH ST APT 1FW NEW YORK, NY 10024-6125

CLAIMANT

County / State

District

MOHAVE County, AZ

COLORADO RIVER DO

Mer Twp Rng Sec

Subdivision

14 0190N 0200W 025

NE, NW, SW, SE

Act Date	Code	Action Text	Action Remarks	Receipt Number
09/29/2016	403	LOCATION DATE		
09/30/2016	395	RECORDATION NOTICE RECD	1	3670731
09/30/2016	484	LOCATION YEAR / MAINTENAN	2017;\$155	3670731
07/14/2017	393	DECISION/NOTICE ISSUED	LODE-NO RIGHTS	
06/19/2017	669	LAND STATUS CHECKED		
09/30/2016	501	ACCT ADV IN LEAD FILE	AMC439831-AMC439832;	
09/29/2016	404	COUNTY RECORDATION	2016044138;	

Line Nr Remarks

RECEIVED
 STATE OFFICE
 2011 AUG 25 A 9: 32
 PHOENIX, ARIZONA

United States Department of the Interior
Bureau of Land Management
 DIV OF LANDS, MINRLS & ENERGY
 ONE N CENTRAL AVE
 PHOENIX, AZ 85004 -4427
 Phone: 602-417-9200

Receipt

No: 3958049

Transaction #: 4067837	
Date of Transaction: 08/25/2017	
CUSTOMER:	
PATRICIA MICHAELS 316 W 79TH ST APT 1-FW NEW YORK, NY 10024-6125 US	

LINE #	QTY	DESCRIPTION	REMARKS	UNIT PRICE	TOTAL
1	1.00	LOCATABLE MINERALS / MINING CLAIMS- NOT NEW-UNADJUD, ONE AUTH NO. ONLY / MINING CLAIM MONEY RECEIVED CASES: AMC439831/\$310.00	2018 MAINT/2	- n/a -	310.00
TOTAL:					\$310.00

PAYMENT INFORMATION			
NOTE: Items will appear on credit card statement as "Bureau of Land Mgmt CO".			
1	AMOUNT:	310.00	POSTMARKED: N/A
	TYPE:	CREDIT CARD	RECEIVED: 08/25/2017
	NAME:	MICHAELS, PATRICIA 316 W 79TH ST APT 1-FW NEW YORK NY 10024-6125 US	
	CARD NO:	XXXXXXXXXXXX1024	AUTH CODE: 128240
	NAME ON CARD:	KADYN MICHAELS	
	EXPIRES:	06/2020	
	SIGNATURE:		

REMARKS

This receipt was generated by the automated BLM Collections and Billing System and is a paper representation of a portion of the official electronic record contained therein.

NOTICE!!

These documents have been scanned!

Do not place un-scanned documents beneath this notice!

Do not remove this notice from this file!

GPO Jacket No. 560-102
Print Order 61540
Rise Business Services, LLC
Job=AZ15 5/1/2019



Box Number= AZ15014



Claim Begin-End: AMC439831-AMC439832

5 Miscellaneous



AZ15014-9

AMC439776-AMC440076

**NO
DOCUMENTS
FOUND**

NO DOCUMENTS FOUND
NO DOCUMENTS FOUND

NOTICE!!

These documents have been scanned!

Do not place un-scanned documents beneath this notice!

Do not remove this notice from this file!

GPO Jacket No. 560-102
Print Order 61540
Rise Business Services, LLC
Job=AZ15 5/1/2019



Box Number= AZ15014



Claim Begin-End: AMC439831-AMC439832

6 Location Notices-Amendments and Supporting Documents



AZ15014-9

AMC439776-AMC440076

MINING CLAIM STATUS REPORT

Data Entered: 09/05/16 Rm

MTP Checked By: 09/05/16 Rm

GEO Checked By: 09/05/16 Rm

LEAD SERIAL NUMBER: AMC 439831 thru AMC 439832

NUMBER OF CLAIMS & TYPE:

2 LODE
PLACER
ASSOCIATION PLACER
MILL SITE
TUNNEL SITE

CHARGES:

Location Fee @ \$37 = \$ 74
Processing Fee @ \$20 = \$ 40
Maintenance Fee @ \$155 = \$ 310
Add'l Maint Fee for Assoc Placer = \$
SUBTOTAL \$
Other Fees \$
Other Fees \$
TOTAL \$ 424

TOTAL ACREAGE: Per Claim
(Placer Only)

NUMBER OF LOCATORS:

DOCUMENTS RECEIVED VIA: Over-the-Counter [X] Mail [] TIMELY FILED: Yes [X] No []

LEGAL DESCRIPTION: T 19N R 20W SEC 25
T R SEC
T R SEC
T R SEC
T R SEC

BLM [X] FOREST SERVICE [] SUBJ TO PL 359: Yes [] No []
WILDERNESS AREA []

SPLIT ESTATE: N/A [] SX [] PX [] OTHER []
SRHA [] Was proper Notice filed if located on SHRA Land? Yes [] No []

RECONVEYED MINERALS ON BLM LAND REQUIRE OPENING ORDER FROM 1944 TO 1993:
Open to Entry On N/A []

COMMENTS/STATUS: VOID [] PARTIALLY VOID [] PVT MINERALS [] WITHDRAWN LANDS []
OTHER []

* Relocating lost claims - 4ml

[] Claimant acknowledges that portions of the following claim(s) site(s) may be void or voidable.

Printed Name of Claimant Signature of Claimant

*****FINAL ADJUDICATION*****

DATE 6/19/2017 INITIALS Rm

AMC 439831

Patricia & Herbert Michaels
316 West 79th Street.
Apt. 1FW
New York, NY. 10024

CONFORMED COPY 1.50
FEE # 2016044137
DATE 9-29-16
BOOK N/A
PAGES 1A

Notice of Lode Mining Claim Re-Location

Locator:
Golden Queen LLC
316 West 79th Street.
Apt. 1FW
New York, NY. 10024

RECEIVED
BLM AZ STATE OFFICE
2016 SEP 30 P 3:24
PHOENIX, ARIZONA

Claim Name: Golden Queen # 1

Date of Re-location: 9-29-2016

This is a relocation of Golden Queen #1
Mohave County Fee # 2004014583
BLM AMC #360017

The Lode Mining Claim is 1500 feet long and 600 feet wide. The location monument is 20 feet from the South End Center and 1480 from the North End Center.

The claim trends generally from the North West to the South East.
The Location Monument is in the SE¼ SE¼ NW¼ of Section 25, Township 19N, Range 20W, Gila and Salt River Meridian. The LM is also 2,015'E then 2,125'S from the North West corner of Section 25, Township 19N, Range 20W.

<u>Location</u>	<u>Markings</u>	<u>Az. State plane grid (West NAD83)</u>
No.1: NW Corner	Metal tag on post	1,458,696.1 Feet N 515,551.6 Feet E
No.2: SW Corner	Metal tag on post	1,457,577.0 Feet N 516,551.3 Feet E
No.3: SE Corner	Metal tag on post	1,457,975.1 Feet N 517,000.9 Feet E
No.4: NE Corner	Metal tag on post	1,459,094.1 Feet N 516,001.2 Feet E

Location monument is a 2" x 2" x 5 foot wooden post. Corner and end center monuments are the same.

Signature Sam Eakin III
Sam Eakin III, Agent for locator

Ed Huskinson 9/29/16
Witness : Ed Huskinson

AHC439831

Map of Golden Queen #1 Lode Claim

Section 25, T19N, R20W
Oatman Mining District
Mohave County, Arizona

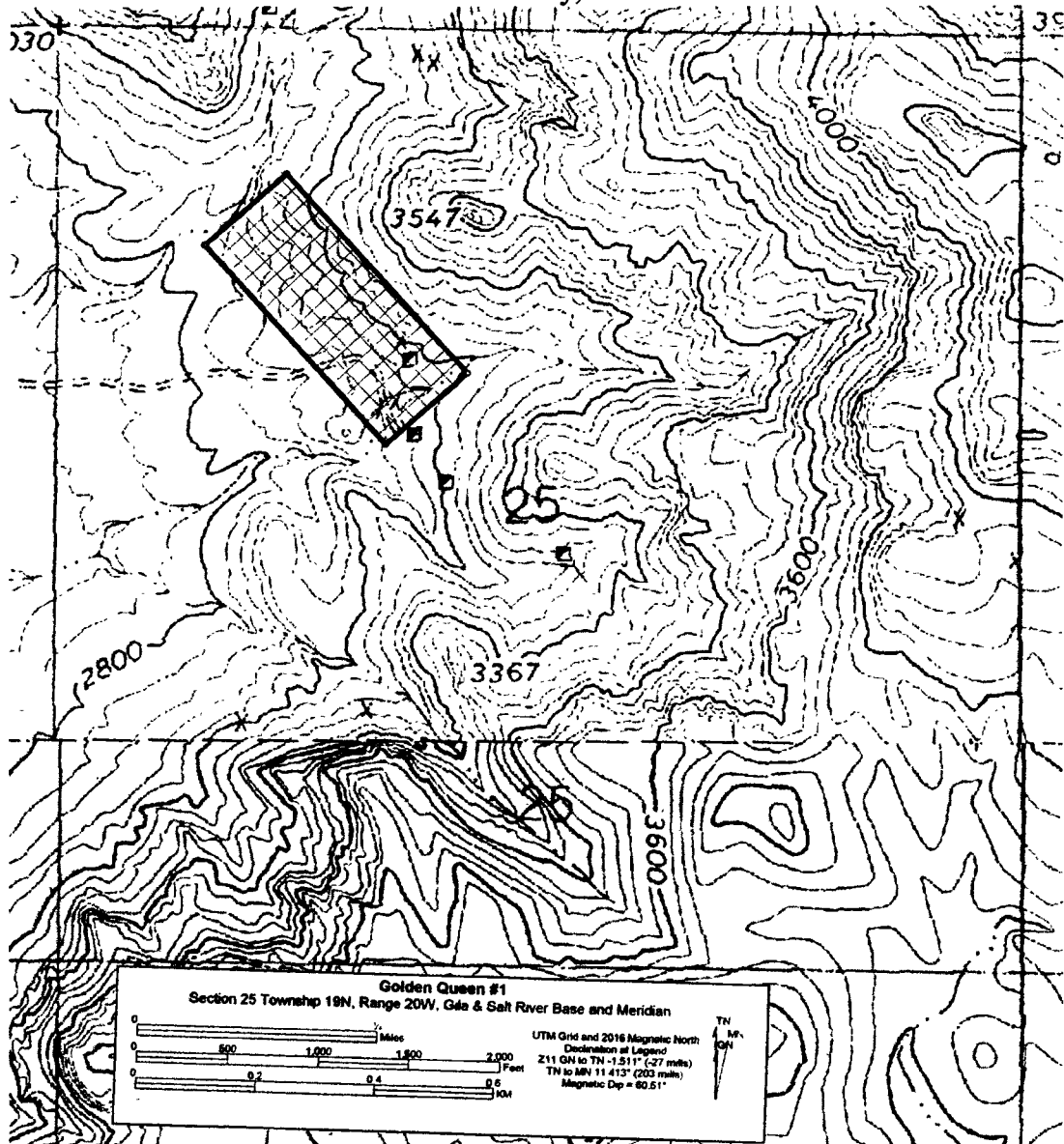

The Claim is delineated thusly: From the NW corner, 1500 feet at approximately 138° to the SW corner, then 600 feet at approximately 48° to the SE Corner, then 1500 feet at approximately 318° to the NE corner, then 600 feet at approximately 228° to the point of beginning.

Patricia & Herbert Michaels
 316 West 79th Street.
 Apt. 1FW
 New York, NY. 10024

CONFORMED COPY 1.50
 FEE # 2016044138
 DATE 9.29.16
 BOOK N/A
 PAGES 107

Notice of Lode Mining Claim Re-Location

Locator:

Golden Queen LLC
 316 West 79th Street.
 Apt. 1FW
 New York, NY. 10024

Claim Name: Golden Queen # 2

Date of Re-location: 9-29-2016

This is a relocation of Golden Queen #2
 Mohave County Fee # 2004014584
 BLM AMC #360018

The Lode Mining Claim is 1500 feet long and 600 feet wide. The location monument is 1480 feet from the South End Center and 20 from the North End Center.

The claim trends generally from the North West to the South East.

The Location Monument is in the SE¼ SE¼ NW¼ of Section 25, Township 19N, Range 20W, Gila and Salt River Meridian. The LM is also 2,041'E then 2,154'S from the North West corner of Section 25, Township 19N, Range 20W.

RECEIVED
 BLM AZ STATE OFFICE
 2016 SEP 30 P 3:24
 PHOENIX, ARIZONA

<u>Location</u>	<u>Markings</u>	<u>Az. State plane grid (West NAD83)</u>
No.1: NW Corner	Metal tag on post	1,457,577.0 Feet N 516,551.3 Feet E
No.2: SW Corner	Metal tag on post	1,456,458.0 Feet N 517,551.0 Feet E
No.3: SE Corner	Metal tag on post	1,456,856.1 Feet N 518,000.7 Feet E
No.4: NE Corner	Metal tag on post	1,457,975.1 Feet N 517,000.9 Feet E

Location monument is a 2" x 2" x 5 foot wooden post. Corner and end center monuments are the same.

Signature Sam Eakin III
 Sam Eakin III, Agent for locator

Ed Huskinson 9/29/16
 Witness : Ed Huskinson

ANCL 39832

Map of Golden Queen #2 Lode Claim

Section 25, T19N, R20W
Oatman Mining District
Mohave County, Arizona

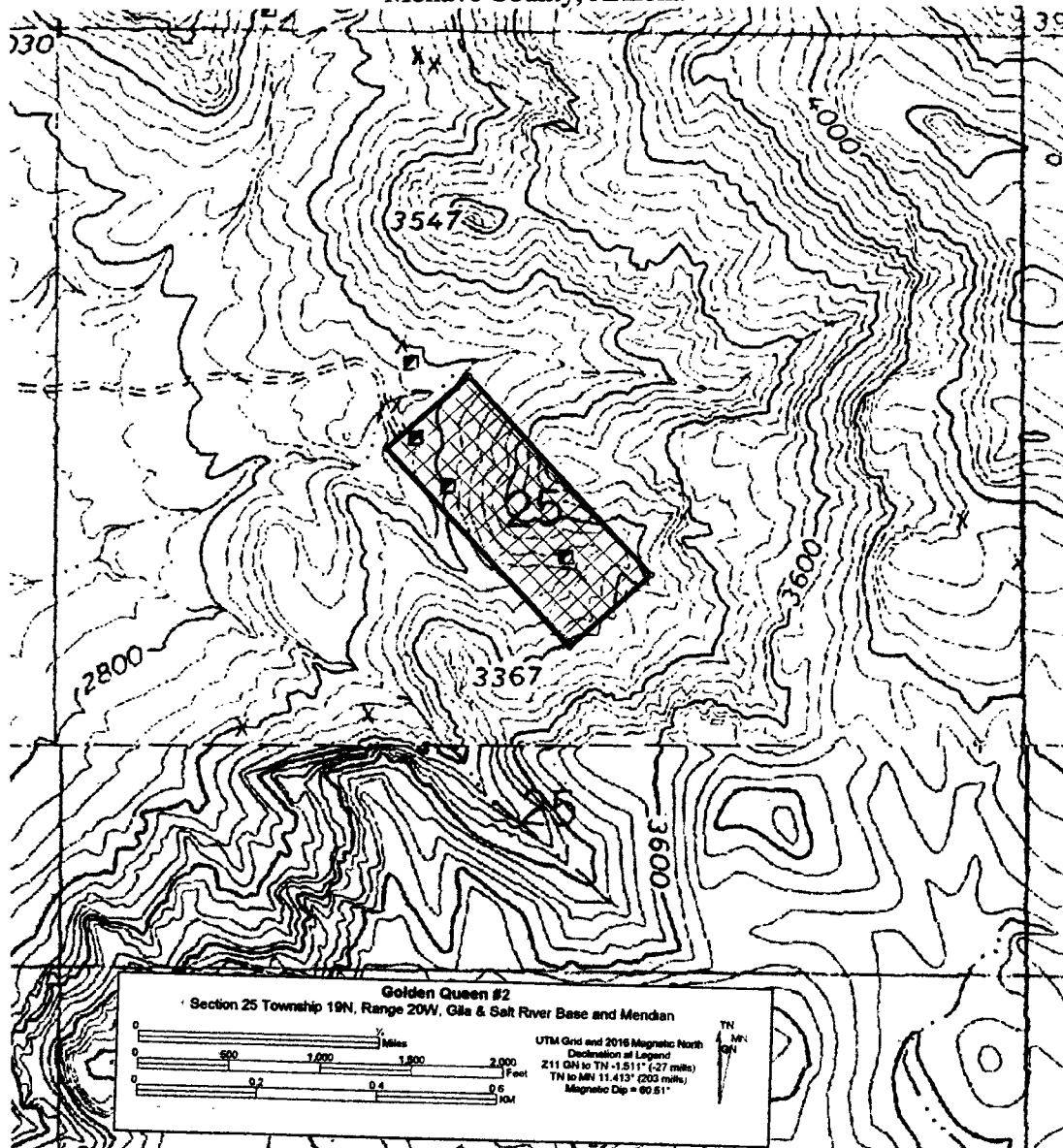

The Claim is delineated thusly: From the NW corner, 1500 feet at approximately 138° to the SW corner, then 600 feet at approximately 48° to the SE Corner, then 1500 feet at approximately 318° to the NE corner, then 600 feet at approximately 228° to the point of beginning.

RUN TIME: 03:21 PM

UNITED STATES DEPARTMENT OF INTERIOR
BUREAU OF LAND MANAGEMENT
GEOGRAPHIC REPORT WITH LAND
Sorted by Serial Number

RUN DATE: 09/30/2016
Page 1 of 1

Serial Number: AZA 025494
Total Case Acres: 112,400.000

<u>Casetype</u>	<u>Case Disp</u>				<u>Sect</u>	<u>Sur Typ</u>	<u>Sur Num</u>	<u>Suff</u>	<u>Subdivision</u>	<u>Act Pend</u>
231106	AUTHORIZED	14	0190N	0200W	025	FF			PART E2NE,S2;	

UNITED STATES DEPARTMENT OF THE INTERIOR
BUREAU OF LAND MANAGEMENT
LIST OF MINING CLAIMS BY SECTION

MTRS: 14 0190N 0200W 025

<u>Serial Number</u>	<u>Quad</u>	<u>Claim Name</u>	<u>Claimant</u>	<u>Lead File</u>	<u>Case Type</u>	<u>Status</u>	<u>Loc Date</u>	<u>Last Assmt</u>
AMC360017	NW	GOLDEN QUEEN #1	THE GOLDEN QUEEN LLC	AMC360017	LODE	ACTIVE	02/19/2004	2016
AMC360018	NE,NW,SW,SE	GOLDEN QUEEN #2	THE GOLDEN QUEEN LLC	AMC360017	LODE	ACTIVE	02/19/2004	2016

TOWNSHIP 19 NORTH RANGE 20 WEST OF THE GILA AND SALT RIVER MERIDIAN, ARIZONA

MOHAVE COUNTY

STATUS OF PUBLIC DOMAIN
LAND AND MINERAL TITLES

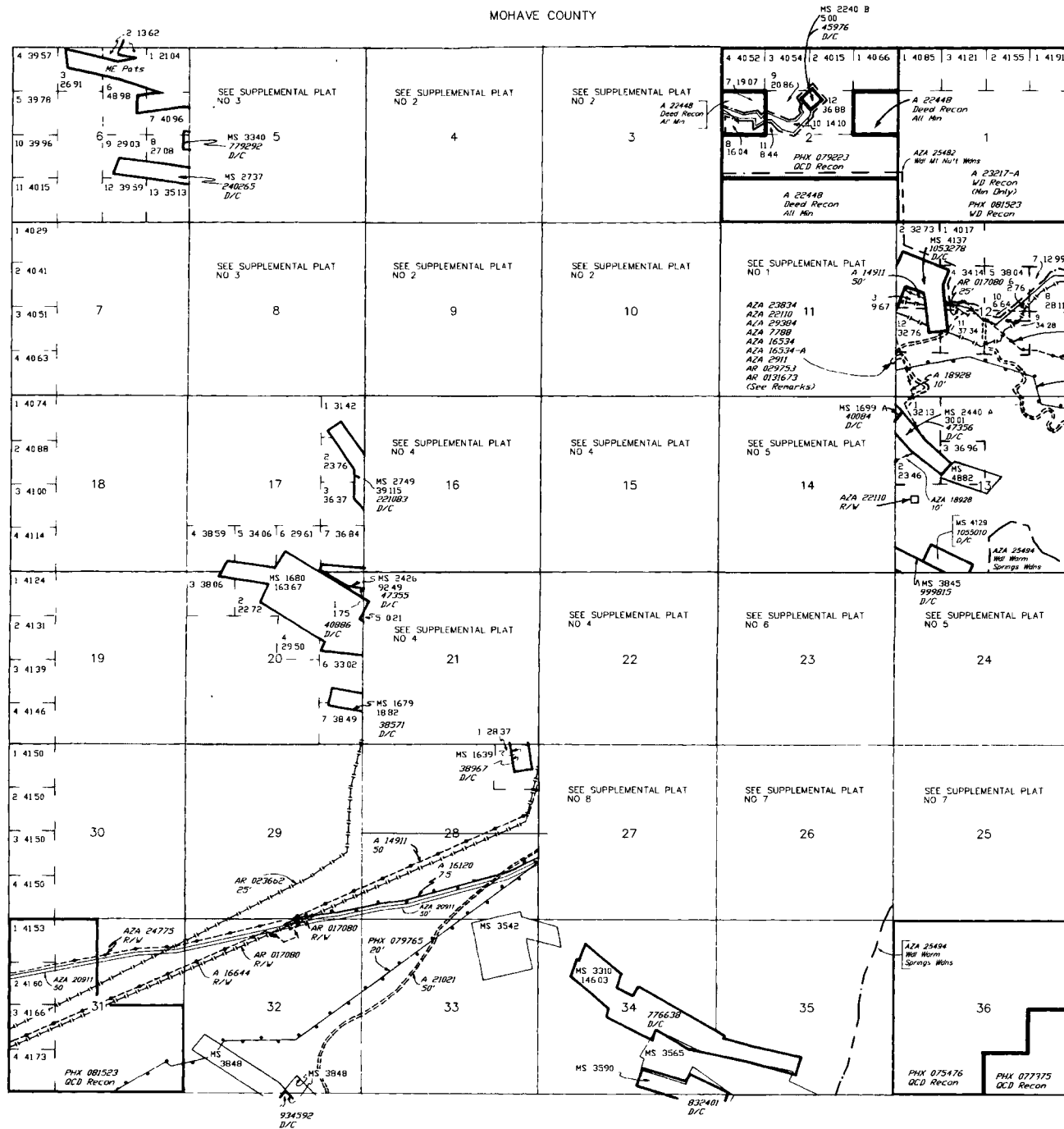

RESURVEY TRACT NO	T	R	SEC	SUBDIVISION

FOR ORDERS AFFECTING DISPOSAL OR USE OF UNIDENTIFIED LANDS WITHDRAWN FOR CLASSIFICATION, MINERALS, WATER AND/OR OTHER PUBLIC PURPOSES, REFER TO INDEX OF MISCELLANEOUS DOCUMENTS

DIST NO 2

GRAZING DIST NO 2

MDS 479 NE

480 NW

481 SW

482 SE

AZA 22110, AZA 23834, AZA 16534, AZA 16534-A, AZA 2911, AR 031673, AR 029753, AZA 7788, AZA 29394 Amended to include Access Road 40' x 4800'

Sec 12 W1/2 SW1/4 SW1/4, SE1/4 SW1/4 SW1/4

Sec 13 W1/2 NW1/4 NW1/4, W1/2 SW1/4 NW1/4

N1/2 NW1/4 SW1/4

Sec 14 SE1/4 NE1/4

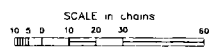

WARNING STATEMENT
This plot is the Bureau's Record of Title, and should be used only as a graphic display of the topographic survey data. Records hereon do not reflect title changes which may have been effected by lateral movements of towers or other means of error. Refer to the cadastral surveys for official survey information.

Lot 34 59'02"N
Long 114 20'10"W

CURRENT TO	GS	T	19 N
6-16-2003	PV	R	20 W

TOWNSHIP 19 NORTH RANGE 20 WEST OF THE GILA & SALT RIVER MERIDIAN, ARIZONA

SECS	SUBDIVISION																Acres	Kind of Entry or Purpose	Serial Number or Order Number	Action Date	Remarks		
	NE 1/4				NW 1/4				SW 1/4				SE 1/4									Lots	Other Description
	NE	NW	SW	SE	NE	NW	SW	SE	NE	NW	SW	SE	NE	NW	SW	SE							
	For orders affecting disposal or use of unidentified lands withdrawn for classification, minerals, water, and/or other public purposes, and Indian treaties, refer to Index to Miscellaneous Documents																						
20																							
21																18.82	PATENT / ME	38571	5/3/1904	MC 549,			
16																							
21																							
28																227.967	PATENT / ME	38967	6/20/1904	MC 552,			
3																							
10																							
11																							
13																							
14																197.93	PATENT / ME	40084	12/13/1904	MC 574,			
17																							
20																							
21																163.67	PATENT / ME	40886	4/19/1905	MC 557,			
22																8.051	PATENT / ME	44342	3/27/1907	MC 118,			
21																							
22																38.879	PATENT / ME	45927	10/25/1907	MC 313,			
2																							
10																							
11																62.66	PATENT / ME	45976	10/31/1907	MC 320			
16																							
17																							
20																							
21																92.49	PATENT / ME	47355	7/27/1908	MC 430			
13																							
14																30.01	PATENT / ME	47356	8/3/1908	MC 431			
22																48.827	PATENT / ME	48447	2/25/1909				
																	STATE GRANT	ACT OF CONGRESS	6/20/1910	TITLE TO STATE TO FIX ON APPROVAL OF SURVEY, SUBJECT TO PRIOR RIGHTS,			
14																							
23																14.501	PATENT / ME	171941	1/21/1911				

TOWNSHIP 19 NORTH RANGE 20 WEST OF THE GILA & SALT RIVER MERIDIAN, ARIZONA

SECS	SUBDIVISION																Acres	Kind of Entry or Purpose	Serial Number or Order Number	Action Date	Remarks			
	NE 1/4				NW 1/4				SW 1/4				SE 1/4									Lots	Other Description	
	NE	NW	SW	SE	NE	NW	SW	SE	NE	NW	SW	SE	NE	NW	SW	SE								
For orders affecting disposal or use of unidentified lands withdrawn for classification, minerals, water, and/or other public purposes, and Indian treaties, refer to Index to Miscellaneous Documents																								
27																		MS 3190,	20 564	PATENT / ME	546604	9/22/1916		
22																								
23																		MS 3196,	6 921	PATENT / ME	593248	7/23/1917		
27																								
28																								
29																								
30																								
31																		M&B, SUBDIV UNDEF,		R/W PIPE LINE	PHX-029288	8/29/1917	18N 22W, REV 8/9/1924,	
14																								
15																		MS 3198,	20 657	PATENT / ME	605892	10/31/1917		
23																								
24																		MS 3199,	66 597	PATENT / ME	605891	10/31/1917		
23																								
24																		MS 3231,	18 236	PATENT / ME	611460	12/10/1917		
24																								
25																		MS 3271,	35 08	PATENT / ME	624215	4/10/1918		
20																								
21																		MS 3235,	124 393	PATENT / ME	624230	4/10/1918		
15																		MS 3237,	35 115	PATENT / ME	631179	5/23/1918		
4																								
5																		MS 3294,	29 35	PATENT / ME	631756	5/28/1918	20N 20W,	
23																		MS 3267,	3 036	PATENT / ME	638313	6/26/1918		
15																		MS 3311,	17 356	PATENT / ME	638531	6/27/1918		
4																		MS 3281,	33 651	PATENT / ME	650997	10/19/1918		
3			X				X							X	X	X			240 00					
10	X			X															80 00					
11			X				X												162 74					
12									X	X	X		X	X		X			240 00					
14				X			X	X	X	X									215 28					
22																			107 11					

TOWNSHIP 19 NORTH RANGE 20 WEST OF THE GILA & SALT RIVER MERIDIAN, ARIZONA

SECS	SUBDIVISION																Acres	Kind of Entry or Purpose	Serial Number or Order Number	Action Date	Remarks		
	NE 1/4				NW 1/4				SW 1/4				SE 1/4									Lots	Other Description
	NE	NW	SW	SE	NE	NW	SW	SE	NE	NW	SW	SE	NE	NW	SW	SE							
For orders affecting disposal or use of unidentified lands withdrawn for classification, minerals, water, and/or other public purposes, and Indian treaties, refer to Index to Miscellaneous Documents																							
27																		MS 3253;	19.487	PATENT / ME	791959	1/26/1921	
14																		MS 3438;	28.111	PATENT / ME	792719	1/29/1921	
10																							
15																		MS 3288;	32.851	PATENT / ME	799693	3/16/1921	
10																							
11																							
14																							
15																		MS 3408;	208.449	PATENT / ME	805049	5/3/1921	
27																		MS 3191;	32.276	PATENT / ME	806014	5/12/1921	
16																		MS 3588;	20.578	PATENT / ME	809400	6/9/1921	
8																							
9																		MS 3262;	118.93	PATENT / ME	829437	10/24/1921	
34																							
35																		MS 3590;	67.679	PATENT / ME	832401	11/15/1921	18N 20W;
23																							
24																							
25																		MS 3505;	176.717	PATENT / ME	859143	4/17/1922	
4																							
5																		MS 3338;	109.705	PATENT / ME	868023	6/15/1922	
14																							
23																		MS 3549;	18.038	PATENT / ME	881135	9/23/1922	
15																		MS 3301;	12.719	PATENT / ME	889095	11/27/1922	
14																							
23																		MS 3300;	98.763	PATENT / ME	908214	6/4/1923	
23																							
26																		MS 3355;	27.672	PATENT / ME	908425	6/8/1923	
14																							
15																		MS 3775;	0.16	PATENT / ME	909601	6/20/1923	
14																							
15																		MS 3188;	160.66	PATENT / ME	916503	9/11/1923	

TOWNSHIP 19 NORTH RANGE 20 WEST OF THE GILA & SALT RIVER MERIDIAN, ARIZONA

SECS	SUBDIVISION																Acres	Kind of Entry or Purpose	Serial Number or Order Number	Action Date	Remarks			
	NE 1/4				NW 1/4				SW 1/4				SE 1/4									Lots	Other Description	
	NE	NW	SW	SE	NE	NW	SW	SE	NE	NW	SW	SE	NE	NW	SW	SE								
For orders affecting disposal or use of unidentified lands withdrawn for classification, minerals, water, and/or other public purposes, and Indian treaties, refer to Index to Miscellaneous Documents																								
3																								
4																								
9																								
10																								
15																		167.364	PATENT / ME	934418	3/22/1924	20N 20W;		
32																		96.699	PATENT / ME	934592	3/26/1924	18N 20W;		
3																								
10																		19.924	PATENT / ME	935866	4/7/1924			
1																		645.52						
31					X			X	X			X	X	X	X	X		1-4	17N 20W;	486.52	PATENT / RRG	946674	10/22/1924	PX WD'S TO US: 8/27/1946;
25																			MS 3614;	2.453	PATENT / ME	946764	10/25/1924	
32																		640.00	IL BASE	88	11/16/1925	8N 6W;		
																			ALL SECS 2, 16, 32, 36;		STATE GRANT	ACT OF CONGRESS	1/25/1927	EXTENDS ACT OF 6/20/1910 TO MINERAL LANDS; SUBJECT TO PRIOR RIGHTS;
13																								
14																								
23																								
24																		130.966	PATENT / ME	999815	4/9/1927			
11																								
12																		115.305	PATENT / ME	1053278	2/9/1932			
3																								
10																		84.365	PATENT / ME	1054007	3/21/1932			
13																								
24																		20.66	PATENT / ME	1055010	5/10/1932			
24																		0.445	PATENT / ME	1055011	5/10/1932			
13																								
14																								
23																								
24																		104.542	PATENT / ME	1055012	5/10/1932			
24																		39.762	PATENT / ME	1058892	10/6/1932			

TOWNSHIP 19 NORTH RANGE 20 WEST OF THE GILA & SALT RIVER MERIDIAN, ARIZONA

SECS	SUBDIVISION																Acres	Kind of Entry or Purpose	Serial Number or Order Number	Action Date	Remarks		
	NE 1/4				NW 1/4				SW 1/4				SE 1/4									Lots	Other Description
	NE	NW	SW	SE	NE	NW	SW	SE	NE	NW	SW	SE	NE	NW	SW	SE							
For orders affecting disposal or use of unidentified lands withdrawn for classification, minerals, water, and/or other public purposes, and Indian treaties, refer to Index to Miscellaneous Documents																							
16																		PART SEC,	80 00	IL BASE	150	3/25/1936	23S 24E,
11																							
12																							
13																							
14																							
22																							
23																							
27																							
28																							
31																							
32																							
33																		M&B SUBDIV UNDEF,	30 898	R/W TELEPHONE AND TELEGRAPH LINE	PHX-079765	11/22/1940	17N 22W, PROOF OF CONSTRUCTION 1/29/1941, APPVD FOR PD ONLY, EXPIRED 11/15/1990, CASE CLOSED,
36													X	X	X			2N 5W,		QCD TO US / SX	PHX-077375	12/20/1940	OPEN TO ENTRY 8/28/1983,
36	X	X	X	X	X	X	X	X	X	X	X	X	X					14N 12W,		QCD TO US / SX	PHX-075476	3/12/1941	O OPENING TO ENTRY 3/21/1982,
1																		ALL,	645 52				
31					X				X	X			X	X	X	X	1-4	13N 14W,	486 52	WD TO US / PX	PHX-081523	8/27/1946	O OPEN TO ENTRY 12/15/1954,
2									X	X			X	X			1-6	19N 19W,		QCD TO US / SX	PHX-079223	6/13/1949	O OPEN TO ENTRY 9/26/1950,
2									X	X			X	X			1-6		397 36	O OPENING TO ENTRY	AR-054653	9/26/1950	
1																		ALL,	645 52				
31					X				X	X	X	X	X	X	X	X	1-4		486 52	O OPENING TO ENTRY	AR-020	12/15/1954	5S 9W,
10													X	X	X		3	LESS PATENTED MINING CLAIMS,					
11					X												1-3	LESS PATENTED MINING CLAIMS,					
12									X	X	X	X						LESS PATENTED MINING CLAIMS,					
15					X				X	X								LESS PATENTED MINING CLAIMS,					
22																	1, 7-9	LESS PATENTED MINING CLAIMS,					
27																	5						

TOWNSHIP 19 NORTH RANGE 20 WEST OF THE GILA & SALT RIVER MERIDIAN, ARIZONA

SECS	SUBDIVISION																Acres	Kind of Entry or Purpose	Serial Number or Order Number	Action Date	Remarks		
	NE 1/4				NW 1/4				SW 1/4				SE 1/4									Lots	Other Description
	NE	NW	SW	SE	NE	NW	SW	SE	NE	NW	SW	SE	NE	NW	SW	SE							
For orders affecting disposal or use of unidentified lands withdrawn for classification, minerals, water, and/or other public purposes, and Indian treaties refer to Index to Miscellaneous Documents																							
28			X	X					X	X	X	X	X	X			1						
29															X	X							
31			X	X					X								3, 4	SESENW, NWNWSE,					
32		X			X	X	X											M&B	R/W GAS PIPELINE	AR-017080	1/31/1958	PERPETUAL, 18N 21W, AMENDED 5/12/1960,	
23																		MS 4386,	14 384	PATENT / ME	1181839	4/30/1958	
14																		N2SENE,	20 00	APLN / WDL COMMUNICATION FACILITY	AR-019688	10/20/1958	WDL PLO 2093 5/24/1960,
10									X	X	X		X				4	LESS PATENTED MINING CLAIMS,					
11			X										X				4, 5	LESS PATENTED MINING CLAIMS,					
12		X	X						X	X			X					LESS PATENTED MINING CLAIMS,					
15					X													LESS PATENTED MINING CLAIMS,					
20															X								
21																	3, 5, 6, 10, 11	LESS PATENTED MINING CLAIMS,					
29	X			X						X	X	X	X	X									
31	X		X	X					X	X							3						
32					X													22N 11E,		R/W PIPELINE	AR-023662	12/2/1959	PERPETUAL,
14																		N2SENE,	20 00	PLO WDL AIR NAVIGATION COMMUNICATION FACILITY	2093	5/24/1960	REV PLO 4149, 1/11/1967,
23																		MS 4477,	2 734	PATENT / ME	1214870	11/30/1960	
14			X																	R/W RADIO AND MICROWAVE RELAY STATION FACILITY	AR-029753	12/7/1960	PREPERMIT, APPVD 9/8/1962, TO TERM 9/7/2012, PROOF OF CONSTRUCTION 6/22/1964, MOD 6/23/1971, AMENDED 1/30/1996,
2																		MS 2204B,	5 00	IL BASE	282	2/2/1961	31N 17W,
23																		MS 4572,	11 780	PATENT / ME	02-63-0031	9/7/1962	
14																		N2SENE,		R/W TRANSMISSION STATION	AR-031673	11/12/1963	EXPIRES 11/11/2013, AMENDED 10/29/1973, AMENDED 11/7/1978, AMENDED 7/7/1981 AMENDED 1/29/1996,
	ENTIRE TOWNSHIP																	16N 19W,		O PROPOSED CL FOR MULTIPLE USE MANAGEMENT	A-156	9/9/1966	SEGREGATES THE LANDS FROM APPROPRIATION UNDER HOMESTEAD, DESERT LAND, ALLOTMENT, PS, SX, PUB IN FR 9/15/1966, O CL 12/6/1966, PUB IN FR 12/21/1966, CL TERM 10/7/1981,
14																		N2SENE,	20 00	PLO REV WDL AIR NAVIGATION SITE, PLO 2093, 5/24/1960	4149	1/11/1967	

TOWNSHIP 19 NORTH RANGE 20 WEST OF THE GILA & SALT RIVER MERIDIAN, ARIZONA

SECS	SUBDIVISION																Acres	Kind of Entry or Purpose	Serial Number or Order Number	Action Date	Remarks		
	NE 1/4				NW 1/4				SW 1/4				SE 1/4									Lots	Other Description
	NE	NW	SW	SE	NE	NW	SW	SE	NE	NW	SW	SE	NE	NW	SW	SE							
For orders affecting disposal or use of unidentified lands withdrawn for classification, minerals, water, and/or other public purposes, and Indian treaties refer to Index to Miscellaneous Documents																							
11																		SE OF CORNER 8		R/W RADIO RELAY STATION	A-996	12/27/1967	TO EXPIRE 12/26/2017, REL AND CASE CLOSED 9/18/1995,
16																			22 17	MINERAL ENTRIES, IL BASE	445	10/24/1968	11N 4W,
10																				PART SESW, R/W CATHODIC PROTECTION STATION SITE	A-4423	10/13/1971	PERPETUAL,
14																				PART SENE, R/W MICROWAVE RELAY STATION SITE	A-2911	8/26/1971	EXPIRES 8/25/2021, AMENDED 1/25/1996,
10																				SENESEW, NESESW, R/W ELECTRIC TRANSMISSION LINE	A-4549	3/3/1972	TO TERM 3/2/2022,
27																				W2SWSWNW, SLUP	A-7640	7/25/1973	EXPIRED 7/24/1974, 23N 18W,
14				X																R/W COMMUNICATION SITE	A-7788	8/22/1974	TO TERM 5/8/2017, AMENDED 10/16/1996, AMENDED 1/25/1996,
27																				W2SWSWNW, O CL / R&PP	A-8177	5/8/1975	SEGREGATED FROM ALL APPROPRIATION INCLUDING LOCATION UNDER THE MINING LAWS, BUT NOT THE MINERAL LEASING LAWS AND R&PP, CL TERM AND O OPENING PUB IN FR 3/21/1996, EFF 4/22/1996, 16N 13W,
27																				W2SWSWNW, LEASE / R&PP	A-8177	10/1/1975	REL 7/27/1995, 16N 20W,
14	X	X	X	X																R/W COMMUNICATION SITE	A-7788A	12/28/1979	CANC AND CASE CLOSED 4/28/1994,
10								X												NE AND SW EXCEPT PATENTED MINING CLAIMS,			
11																		1-3					
12									X										X	S2NW EXCEPT PATENTED MINING CLAIMS,			
15							X				X	X											
22																		8, 9, AND 1, 7 EXCEPT PATENTED MINING CLAIMS					
27							X											5					
28				X					X	X	X	X	X	X	X	X	X						
29													X	X	X	X							
32		X																		R/W TRANSMISSION LINE	A-14911	12/29/1980	PERPETUAL,
22																		11, LESS PATENTED MINING CLAIMS					

TOWNSHIP 19 NORTH RANGE 20 WEST OF THE GILA & SALT RIVER MERIDIAN, ARIZONA

SECS	SUBDIVISION																Acres	Kind of Entry or Purpose	Serial Number or Order Number	Action Date	Remarks		
	NE 1/4				NW 1/4				SW 1/4				SE 1/4									Lots	Other Description
	NE	NW	SW	SE	NE	NW	SW	SE	NE	NW	SW	SE	NE	NW	SW	SE							
For orders affecting disposal or use of unidentifed lands withdrawn for classification, minerals, water, and/or other public purposes, and Indian treaties, refer to Index to Miscellaneous Documents																							
27							X	X			X							SWNE LESS PATENTED MINING CLAIMS.					
28									X	X	X	X	X	X	X	X							
29															X	X							
32	X																		RW BURIED TELEPHONE CABLE	A-16120	1/2/1981	TO TERM 1/1/2011,	
31		X	X						X					X			3, 4						
32	X				X	X	X	X											RW ELECTRIC DISTRIBUTION LINE	A-16644	6/16/1981	TO TERM 6/15/2011, OTHER TPS 18N 21W, 19N 21W,	
36													X	X	X				O OPENING TO ENTRY	PHX-077375	8/28/1981	2N 5W,	
3		X					X						X	X			3, 5						
10																	1-3						
11			X			X											4-8	EXCEPT PATENTED MINERAL ENTRIES.					
12									X	X	X		X	X		X		EXCEPT PATENTED MINERAL ENTRIES.					
14				X			X	X	X								3, 4	EXCEPT PATENTED MINERAL ENTRIES.					
22																	3, 4, 11	EXCEPT PATENTED MINERAL ENTRIES.					
23			X	X			X						X				1, 3-5, 7	EXCEPT PATENTED MINERAL ENTRIES.					
24										X								EXCEPT PATENTED MINERAL ENTRIES, ALL LANDS LYING WITHIN 50 FT OF CENTER LINE OF TRANSMISSION LINE.	PLO REV PWR SITE RESERVE 719, EO 5/24/1919	5992	10/7/1981	20N 17W, PD LANDS OPEN TO ENTRY AT 10 00 AM ON 10/7/1981,	
36	X	X	X	X	X	X	X	X	X	X	X	X	X						O OPENING TO ENTRY	PHX-075476	3/21/1982	14N 12W,	
19	X	X	X	X	X			X	X			X	X	X	X	X	1-4						
29																		ALL,	1285 40	LEASE / OG	A-14590	4/5/1982	EFF 5/1/1982, TERM 5/1/1984, OG SIM DEC 1984,
31	X	X	X	X																			
32																		ALL,	800 00	LEASE / OG	A-14774	4/5/1982	EFF 5/1/1982, TERM 5/1/1985, OG SIM DEC 1985,
17		X	X		X	X	X	X	X	X	X			X			1-7						
30	X	X	X	X	X			X	X			X	X	X	X	X	1-4						
35																		ALL, LESS MS 3310, MS 3565,	1786 65	LEASE / OG	A-14370	4/8/1982	EFF 5/1/1982, TERM 5/1/1985, OG SIM PART DEC 1985,

TOWNSHIP 19 NORTH RANGE 20 WEST OF THE GILA & SALT RIVER MERIDIAN, ARIZONA

SECS	SUBDIVISION																Acres	Kind of Entry or Purpose	Serial Number or Order Number	Action Date	Remarks		
	NE 1/4				NW 1/4				SW 1/4				SE 1/4									Lots	Other Description
	NE	NW	SW	SE	NE	NW	SW	SE	NE	NW	SW	SE	NE	NW	SW	SE							
For orders affecting disposal or use of unidentified lands withdrawn for classification, minerals, water, and/or other public purposes, and Indian treaties, refer to Index to Miscellaneous Documents																							
14																		N2SENE,	R/W ELECTRIC DISTRIBUTION LINE	A-18928	10/31/1983	TO TERM 10/30/2013, AMENDED 10/15/1987, AMENDED 3/30/1988, AMENDED 8/10/1988.	
14																		N2SENE,	R/W RADIO SITE AND ACCESS ROAD	A-16534	10/31/1983	TO TERM 10/30/2013, AMENDED 8/3/1988, AMENDED 1/25/1996, CANC 6/3/1996, CASE CLOSED 8/15/1996.	
3											X												
4									X	X	X	X	X	X	X	X							
5																	2, 3, 8						
10					X	X	X	X	X	X	X	X				X							
15																	6, 7	R/W ROAD	A-20912	7/3/1985	PERPETUAL, EFF 12/19/1984, OTHER TPS 20N 20W, 20N 21W,		
14																	12						
23																	11-14, 16	0.33 R/W ROAD	A-21057	7/10/1985	PERPETUAL,		
28									X	X	X	X	X	X	X	X							
29																		S2S2SE,					
31	X	X	X	X													2	N2SENE,					
32		X			X	X												LD TP 18N 21W,	R/W ROAD	A-20911	8/7/1985	PERPETUAL,	
10																	4	E2SWSE EXCL MS 3408,					
11																	4-6, 8						
12									X	X								NWSWSW, SWNWSE, N2SWSE, SESWSE,					
13	X	X																					
15			X	X																			
22																	13, 14						
23																	7, 10-12, 15, 17						
27																	8, 9	SESESWNW, N2NW2SW, NWSWNWSW,					
28																X		S2NESE, NWSESE,					
32													X			X							
23					X													NWNWNWNE, E2SWNW, NWSWSE, N2NWSW,	R/W ROAD	A-21021	8/7/1985	PERPETUAL, AMENDED 9/3/1986,	
14																	12		0.41				

TOWNSHIP 19 NORTH RANGE 20 WEST OF THE GILA & SALT RIVER MERIDIAN, ARIZONA

SECS	SUBDIVISION																Acres	Kind of Entry or Purpose	Serial Number or Order Number	Action Date	Remarks		
	NE 1/4				NW 1/4				SW 1/4				SE 1/4									Lots	Other Description
	NE	NW	SW	SE	NE	NW	SW	SE	NE	NW	SW	SE	NE	NW	SW	SE							
For orders affecting disposal or use of unidentified lands withdrawn for classification, minerals, water, and/or other public purposes, and Indian treaties, refer to Index to Miscellaneous Documents																							
23																	11-14, 16, 17		4.96	NORA	A-20295	11/7/1985	SEGREGATED FROM THE PUBLIC LAND LAWS AND THE MINING LAWS, OPEN TO THE MINERAL LEASING LAWS, SEG TO TERM 8/4/1986, REF A-20296, A-20300).
28																X		S2NESE, NWSESE, SEENESE, SESENWSE, SESESESW,					
33					X													NWNWNWNE, E2SWNW, NWSENW, N2NWSW, NWSWSENW, S2SWSWNW,			A-21021	9/3/1986	PERPETUAL,
14																		N2SENE,			A-18534A	12/10/1986	TO TERM 12/10/2006,
12						X				X									0.29	R/W COMMUNICATION SITE	A-22110	3/11/1987	TO TERM 3/10/2017, AMENDED 1/26/1996,
23																	11		0.62	PATENT / PS	02-87-0022	5/1/1987	(A-20295),
23																	12, 13		2.13	PATENT / PS	02-87-0023	5/1/1987	(A-20296),
23																	14		0.71	PATENT / PS	02-87-0024	5/1/1987	(A-20297),
23																	16		0.60	PATENT / PS	02-87-0025	5/1/1987	(A-20298),
23																	17		0.90	PATENT / PS	02-87-0026	5/1/1987	(A-20299),
14																	12		0.41	PATENT / PS	02-87-0027	5/1/1987	(A-20300),
2			X			X				X	X				X	X					A-22448	5/12/1987	
14																	10, 11				A-22845	8/7/1987	TO TERM 8/6/1990, AMENDED 2/12/1988, EXPIRED AND CASE CLOSED 12/4/1992,
11																	8						
14			X														1, 5		1.19	R/W POWER LINE AMENDED	A-18928	10/15/1987	TO TERM 10/13/2013, AMENDED 3/30/1988
2			X			X				X	X				X	X					A-22448	1/14/1988	AT 9 00 AM ON 2/16/1988, THE LANDS WILL BE OPENED TO THE PUBLIC LAND LAWS,
11			X														4						
12							X				X												
13																	1, 2						
14			X																2.56	R/W ELECTRIC DISTRIBUTION LINE AMENDED	A-18928	3/30/1988	TO TERM 10/13/2013, PART REL 8/10/1988,
11			X														4						
12							X	X															
13																	1, 2						
14			X																		A-18928	8/10/1988	TO TERM 10/13/2013,

TOWNSHIP 19 NORTH RANGE 20 WEST OF THE GILA & SALT RIVER MERIDIAN, ARIZONA

SECS	SUBDIVISION																Acres	Kind of Entry or Purpose	Serial Number or Order Number	Action Date	Remarks		
	NE 1/4				NW 1/4				SW 1/4				SE 1/4									Lots	Other Description
	NE	NW	SW	SE	NE	NW	SW	SE	NE	NW	SW	SE	NE	NW	SW	SE							
For orders affecting disposal or use of unidentified lands withdrawn for classification, minerals, water, and/or other public purposes, and Indian treaties, refer to Index to Miscellaneous Documents																							
1			X	X			X	X	X	X	X	X	X	X	X	X	1-4		WD RECON	A-23217-A	10/26/1988	LD TP 10N 15W,	
13																		M&B	AZA-23834	7/6/1989	TO TERM 7/5/2019, AMENDED 8/30/1990, AMENDED 1/27/1992, AMENDED 1/25/1996,		
1																		ALL,					
2			X						X	X			X	X			1, 3, 4, 7-9, 11 PART 2, 12						
3																	1, 2, 6, 8, 9						
12	X	X															1, 2, 4, 5, 7, 10	LD TP 19N 19W,	AZA-25482	11/28/1990	SEGREGATED FROM THE PUBLIC LAND LAWS AND THE MINING LAWS, INCLUDING THE MINERAL LEASING LAWS, PERPETUAL,		
13																		PART SE,					
24																		PART E2,					
25																		PART E2NE, S2,					
26																		PART SESESE,					
35																		PART E2NE, E2SE, E2SWSE,					
36																		ALL, LD TP 17N 18W,	AZA-25494	11/28/1990	SEGREGATED FROM THE PUBLIC LAND LAWS AND THE MINING LAWS, INCLUDING THE MINERAL LEASING LAWS, PERPETUAL,		
10																		LOT 4 EXCEPT PAT LAND					
11			X															4, 5,					
12																		6, 8, 9, 11 12,					
15																		9,					
21																		3, 5, 6, 10, 11,					
28					X																		
29	X			X									X	X	X	X							
31	X	X	X	X				X										3,					
32					X	X	X	X											AZA-24819	08/16/1991	TO TERM 8/15/2021,		
14									X									0 70 R/W WELL STORAGE TANK AND ACCESS ROAD	AZA-27075	1/12/1993	TO TERM 1/11/2023,		
10																X							
15																	6	0 73 R/W POWER LINE	AZA-28810	1/31/1995	TO TERM 1/30/2025,		
10																X							
15																	6	0 92 R/W AERIAL TELEPHONE CABLE	AZA-28811	1/31/1995	TO TERM 1/30/2025,		

TOWNSHIP 19 NORTH RANGE 20 WEST OF THE GILA & SALT RIVER MERIDIAN, ARIZONA

SECS	SUBDIVISION																Acres	Kind of Entry or Purpose	Serial Number or Order Number	Action Date	Remarks		
	NE 1/4				NW 1/4				SW 1/4				SE 1/4									Lots	Other Description
	NE	NW	SW	SE	NE	NW	SW	SE	NE	NW	SW	SE	NE	NW	SW	SE							
For orders affecting disposal or use of unidentified lands withdrawn for classification, minerals, water, and/or other public purposes, and Indian treaties, refer to Index to Miscellaneous Documents																							
14			X															4 54	R/W COMMUNICATION SITE	AZA-29384	1/23/1996	TO TERM 10/15/2015, AMENDED 1/25/1996,	
12																							
13																		4 40	R/W MICROWAVE RELAY STATE SITE AMENDED	AZA-2911	1/25/1996	TO TERM 8/25/2021, AMENDED 5/5/2016,	
12																							
13																			R/W COMMUNICATION SITE AMENDED	AZA-7788	1/25/1996	TO TERM 5/8/2017, AMENDED 5/9/1997,	
12																							
13																							
14			X															4 99	R/W RADIO SITE AND ACCESS ROAD AMENDED	AZA-16534	1/25/1996	TO TERM 10/30/2013, CANC 6/3/1996, CASE CLOSED,	
12																							
13																							
14			X															4 835	R/W COMMUNICATION SITE AMENDED	AZA-23834	1/25/1996	TO TERM 7/5/2019,	
12																							
13																			R/W COMMUNICATION SITE AMENDED	AZA-29384	1/25/1996	TO TERM 10/15/2015,	
12																							
13																							
14			X															4 69	R/W COMMUNICATION SITE AMENDED	AZA-22110	1/26/1996	TO TERM 3/26/2018,	
12																							
13																		4 40	R/W TRANSMISSION STATION AMENDED	AZAR-031673	1/29/1996	TO TERM 11/11/2013,	
12																							
13																		4 40	R/W RADIO AND MICROWAVE RELAY STATION FACILITY AMENDED	AZAR-029753	1/30/1996	TO TERM 9/7/2012,	
27																							
10																	4		W2SWSE,				

TOWNSHIP 19 NORTH RANGE 20 WEST OF THE GILA & SALT RIVER MERIDIAN, ARIZONA

SECS	SUBDIVISION																Acres	Kind of Entry or Purpose	Serial Number or Order Number	Action Date	Remarks			
	NE 1/4				NW 1/4				SW 1/4				SE 1/4									Lots	Other Description	
	NE	NW	SW	SE	NE	NW	SW	SE	NE	NW	SW	SE	NE	NW	SW	SE								
For orders affecting disposal or use of unidentified lands withdrawn for classification, minerals, water, and/or other public purposes, and Indian treaties, refer to Index to Miscellaneous Documents																								
11																	5							
15																	6	0.98 RW WATER PIPELINE	AZA-30409	2/9/1998	TO TERM 2/8/2008, AMENDED 4/29/1998, RENEWED 6/23/2010, TO TERM 12/31/2038,			
3																	13-15							
4								X					X	X			3, 4	SWSWNE,		R/W WATER PIPELINE	AZA-30410	3/31/1998	TO TERM 3/30/2008,	
12																		W2SWSW, SESWSW,						
13																		W2NWNW, W2SWNW, N2NWSW,						
14			X																	R/W COMMUNICATION SITE	AZA-33195	9/13/2005	TO TERM 01/01/2015, 9/9/2014 RENEWAL APPLICATION FILED, 5/6/2015 COMPLIANCE APPROVED,	
14																		NWSENE,		R/W WEATHER MON STA	AZA-33623	8/14/2006	PERPETUAL,	
27																		SESWNW,		R/W WEATHER MON STA	AZA-33625	8/14/2006	PERPETUAL,	
10								X					X							R/W POWER LINE	AZA-34457	6/17/2008	TO TERM 12/31/2039,	
6																	9			R/W WEATHER MON STA	AZA-34959	6/21/2011	TO TERM 12/31/2041,	
12																		W2SWSW, SESWSW,						
13																		W2NWNW, S2NWSWNW, N2SWSWNW,						
14			X																4.63	R/W COMMUNICATION SITE AMENDED	AZA-2911	5/5/2016	TO TERM 8/25/2021,	

TOWNSHIP 19 NORTH RANGE 20 WEST OF THE GILA AND SALT RIVER MERIDIAN, ARIZONA

MOHAVE COUNTY

STATUS OF PUBLIC DOMAIN
LAND AND MINERAL TITLES

MTP
SUPPL SECS 25,26

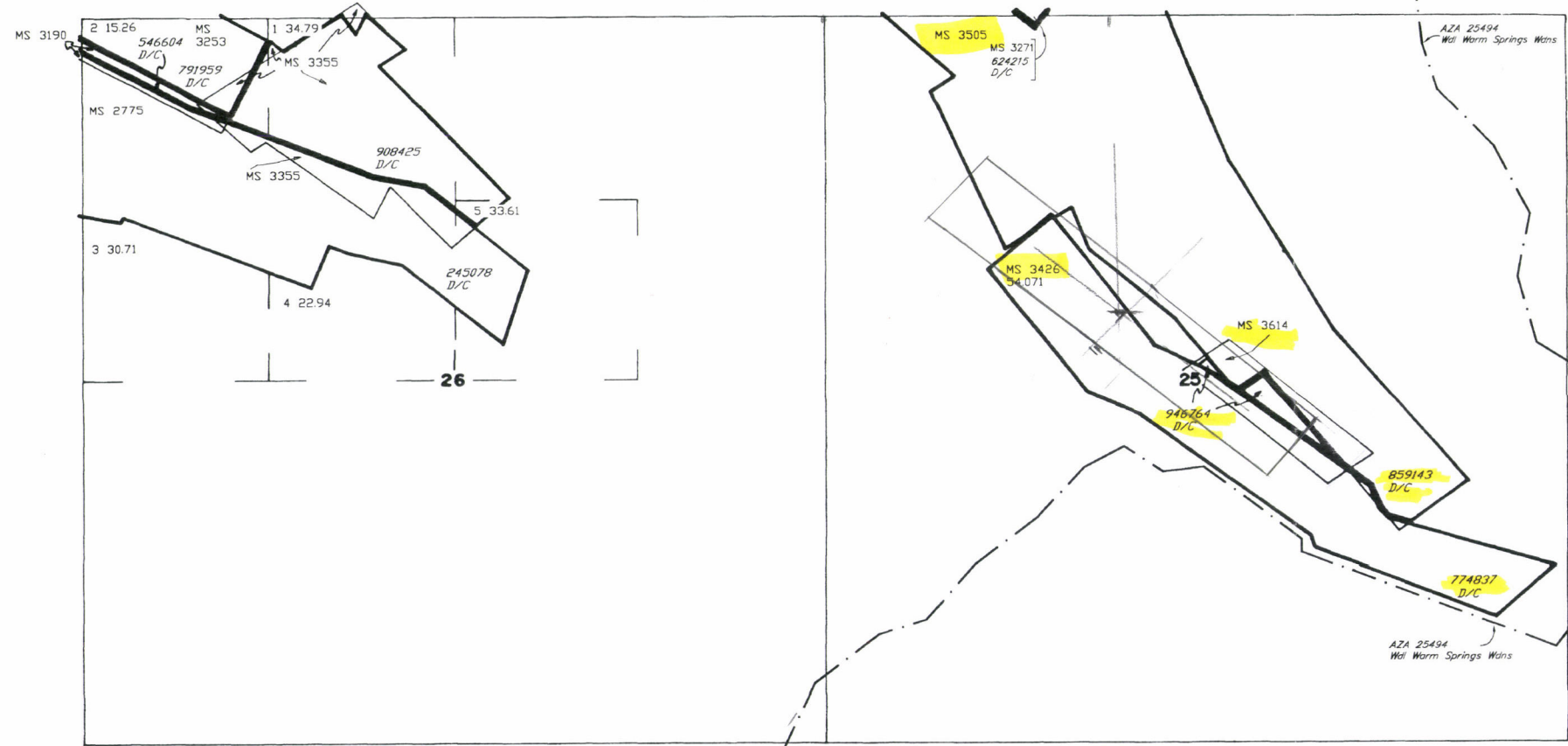

RESURVEY	ORIGINAL SURVEY		
TRACT NO	T	R	SEC

FOR ORDERS AFFECTING DISPOSAL OR USE OF UNIDENTIFIED LANDS WITHDRAWN FOR CLASSIFICATION, MINERALS, WATER AND/OR OTHER PUBLIC PURPOSES, REFER TO INDEX OF MISCELLANEOUS DOCUMENTS.

DIST NO 2

GRAZING DIST NO 2

MDS 482 SE

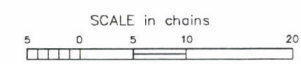

WARNING STATEMENT
This plat is the Bureau's Record of Title, and should be used only as a graphic display of the township survey data. Records hereon do not reflect title changes which may have been effected by lateral movements of rivers or other bodies of water. Refer to the cadastral surveys for official survey information.

CURRENT TO	MM	
5-21-2003	PV	T 19 N
		R 20 W